

MAP OF A SURVEY
FOR
PAUL & DEBORAH DEMKO
PART OF ORIGINAL LOT No. 44
BURETTON TOWNSHIP — GEauga COUNTY — OHIO

CURVE DATA

Delta	08° 15' 26"
Radius	1338.81
Arc	193.07
Chord	192.91
Chord Bearing	N. 50° 20' 55" E

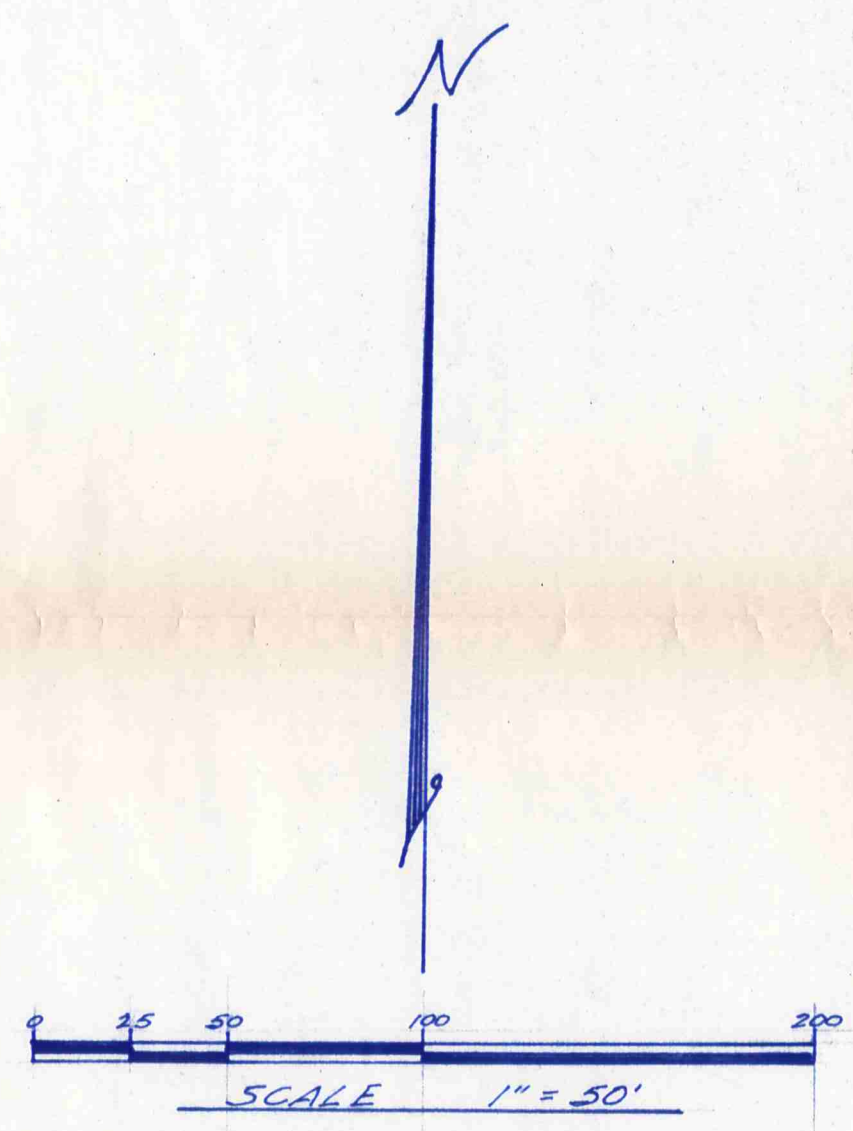

NOTE: Bearings shown here on are based on an assumed meridian and are used to indicate angles only.

I certify this survey is in accordance with the provisions of Chapter 4733-37 of the Ohio Administrative Code.

J. Arthur Temple
J. Arthur Temple
Registered Surveyor #4761
July 2002



SURVEY PLAT & LEGAL DESCRIPTION
APPROVED PER R.C. 315.251
R.S. 7/19/02
OFFICE OF THE
GEAUGA COUNTY ENGINEER

5.141 Ac.

P. Daniel, Jr. & Deborah D. Demko
Vol. 1166 p. 215

90° 54' 17" angle taken from County Engineers survey dated Dec. 1, 1989

**DESCRIPTION FOR
DEMKO**

Situated in the Township of Burton, County of Geauga, State of Ohio and being part of Original Lot No. 44 within said Township and further described as follows;

Beginning in the centerline of Bigelow Road at the intersection of said centerline with the south margin of land conveyed to the City of Akron by deed recorded in Vol. 189 Pg. 87 of the Geauga County Records of Deeds, said point of beginning being referenced by a 1 inch iron pipe found in the centerline of Bigelow Road at a point which is North 04° 30' 00" East a distance of 37.15 feet, said iron pipe being at the intersection of Bigelow Road with the centerline of the former Cleveland and Eastern Railroad right of way, currently in the name of the City of Akron as noted above;

Thence along the southerly line of the said City of Akron land by the arc of a curve to the right, an arc distance of 193.07 feet to a City of Akron monument found at the point of tangency of said curve, said curve having delta of 08° 15' 46", a radius of 1338.81 feet with a chord which bears North 50° 20' 55" East a chord distance of 192.91 feet;

Thence North 54° 28' 29" East, continuing along the southerly line of said City of Akron land a distance of 250.12 feet to a 5/8 inch iron pin set;

Thence South 04° 30' 00" West a distance of 822.31 feet to a 5/8 inch iron pin set in the centerline of Bigelow Road;

Thence North 84° 35' 43" West along the centerline of Bigelow Road a distance of 330.00 feet to a 1 1/4 inch iron pipe found at an angle point;

Thence North 04° 30' 00" East continuing along the centerline of Bigelow Road a distance of 521.88 feet to the place of beginning, containing within said bounds 5.141 acres of land, according to the survey of J. Arthur Temple, Registered Surveyor No. 4761 dated July 2002.

Bearings shown herein are based on an assumed meridian and are used to indicate angles only.

Previous recording: Vol. 1166, Pg. 215.

SURVEY PLAT & LEGAL DESCRIPTION
APPROVED PER R.C. 315.251

R.S. 7/9/02
OFFICE OF THE
GEAUGA COUNTY ENGINEER